

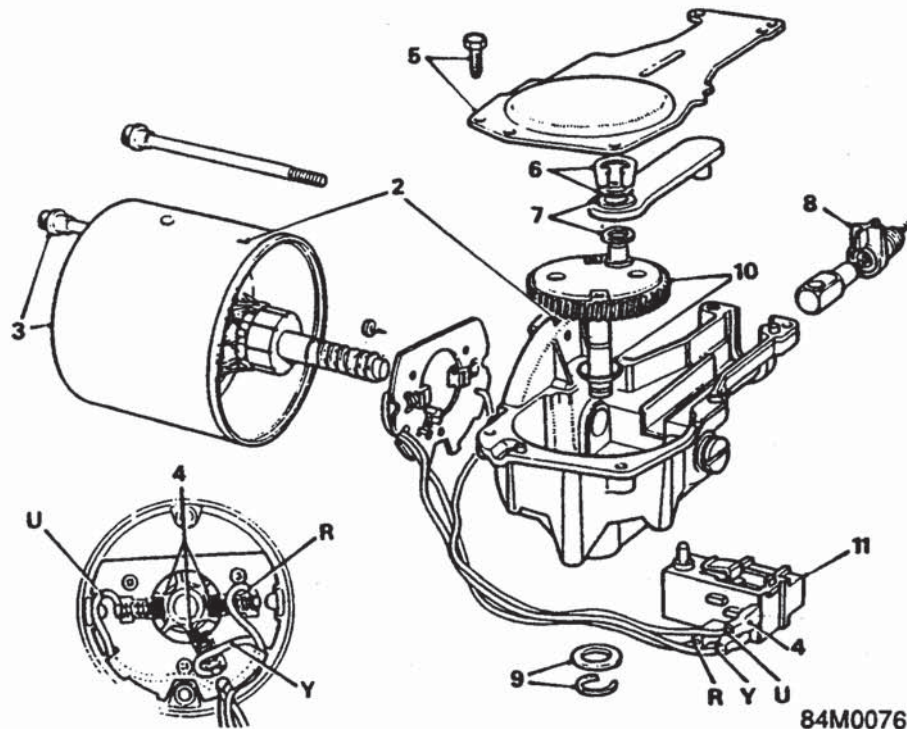

WIPER MOTOR OVERHAUL

Service Repair No. 84.15.18



84M0076

Dismantle

Note: To change brushes only, follow procedures 1 to 4.

1. Remove the wiper motor and drive, see **Wiper motor**
2. Note alignment marks on the yoke and gearbox for assembly.
3. Remove the two through-bolts and remove the yoke and armature assembly.

CAUTION: The yoke must be kept clear of metal particles which will be attracted to the pole-piece.

4. Note the colour and position of the wiring. Withdraw the brushes from the insulating plate and disconnect the leads from the switch assembly.

Wire colours:

R = Red. U = Blue. Y = Yellow.

5. Remove the four gearbox cover retaining screws and remove the cover.
6. Remove the circlip and flat washer from the connecting rod to the crank pin.
7. Withdraw the connecting rod and the flat washer fitted under it.
8. Withdraw the cable rack with cross-head and outer casing ferrule.
9. Remove the circlip and washer securing the shaft and gear.

10. Clean up any burrs from the gear shaft and withdraw the gear, taking care not to lose the dished washer fitted under it.
11. Park switch assembly: Pull outwards and down to release the retaining clips.

Inspection

12. Examine the brushes if the main brushes (diametrically opposite) are worn to 4.8 mm (0.19 in), or if the narrow section of the third brush is worn to the full width of the brush, the brushes must be renewed. Renew the brush gear assembly if the springs are not satisfactory.

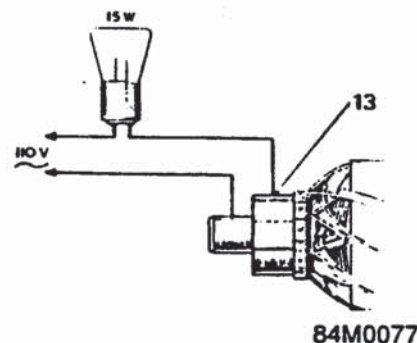

84M0077

13. Test the armature for insulation and open or short circuits. Use a test lamp (110 volts, 15 watts). Renew if the armature is faulty.