



FUEL SYSTEM - PRESSURE TEST

Service repair no - 19.50.13

Remove

1. Position absorbent cloth around fuel line quick fit connector.

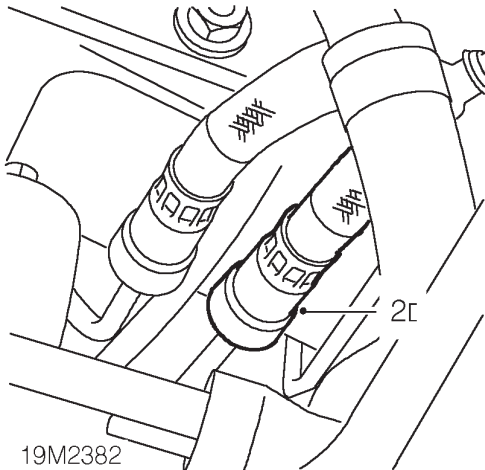

2. Release quick fit connector and disconnect fuel feed hose from fuel pipe.

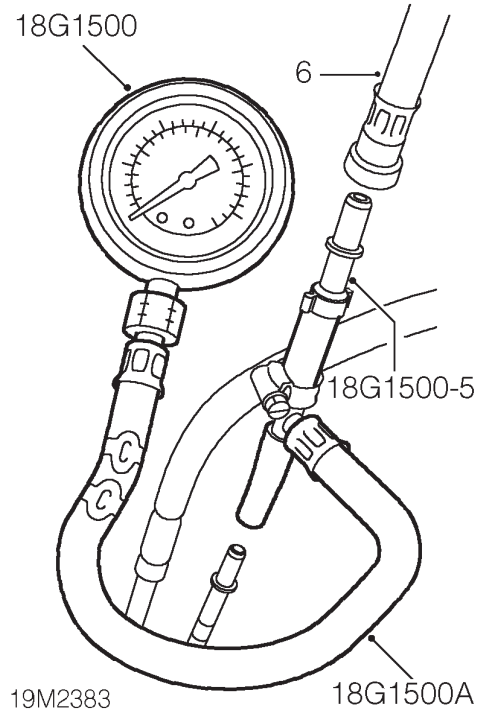

3. Fit adapter hose **18G 1500-A** to fuel pipe.
4. Fit adaptor **18G 1500-5** to **18G 1500-A**.
5. Fit pressure gauge **18G 1500** to **18G 1500-A**.
6. Connect fuel feed hose quick fit connector to **18G 1500-5**.
7. Start engine check reading and pressure drop over one minute and then stop engine.
8. Disconnect quick fit connector from **18G 1500-5**.
9. Remove **18G 1500** from **18G 1500-A**.
10. Remove **18g 1500-5** from **18G 1500-A**.
11. Remove **18G 1500-A** from fuel pipe.
12. Clean end of fuel pipe.
13. Connect fuel feed hose connector to fuel feed pipe.

CAUTION: Ensure quick fit connector is correctly engaged on fuel pipe.

14. Remove cloth positioned to absorb fuel spillage.